



BLACK KNIGHT LOW TANK GAUGE



485 North Charlotte Avenue
Waynesboro, Virginia 22980 USA
(540) 932-8574
Fax: (540) 932-8594
www.bjenterprisesinc.com

The Black Knight tank gauge will display how many inches of fluid are left until tank is empty. The Black Knight is easily adjustable for use on tanks up to 99 inches in depth. Please follow the instructions carefully to prevent damage to the Black Knight.

CAUTION: THE BLACK KNIGHT IS NOT RECOMMENDED OR INTENDED TO BE USED IN COMBUSTIBLE OR HIGHLY FLAMIBLE LIQUIDS

Adjustment Procedure And Installation Instructions

STOP! Understand instructions before proceeding.

1. Determine depth of tank (i.e. 60 inches)
2. Using plastic loop, pull shipping foam insert ***flush*** with bottom of nipple. *See Figure 1.*
3. With shipping foam insert flush with bottom of nipple, pull chain until display reads 60 inches.

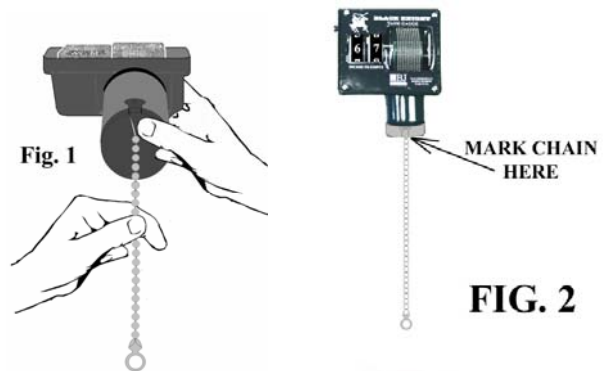

4. Mark chain with magic marker at bottom of nipple. *See Figure 2*
5. Pull chain out another 1 ½ ft. and remove eyelet from end of chain and save.

6. Cut chain on mark and attach float assembly using saved eyelet as shown.

See Figure 3

7. Using plastic loop, completely remove shipping foam insert and discard.

8. Assure gauge is functioning properly.

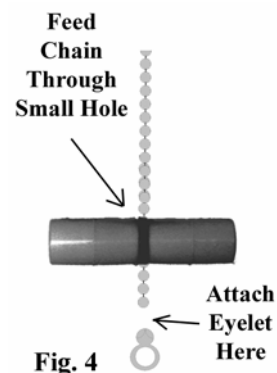

Continued On Back

9. Apply Teflon tape or pipe sealant to nipple threads.

10. Insert float assembly into pre-selected 2-inch NPT tank bung and use the chain to lower the float assembly. *See Figure 5*

Caution: Never let float assembly drop to the bottom. Always use chain to lower float. *See Figure 6*

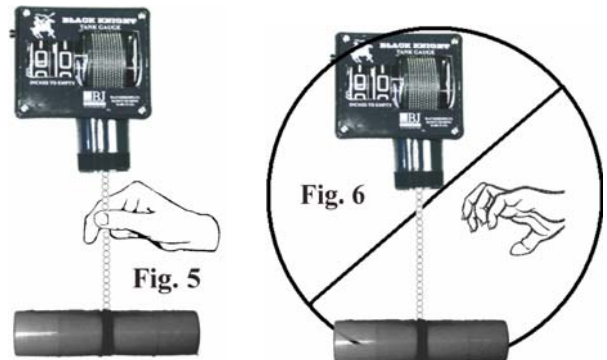

11. Tighten gauge into tank using a pipe wrench on the nipple only. *See Figure 7*



Caution: Never use housing as wrench. *See Figure 8*

12. Installation is now complete.

